

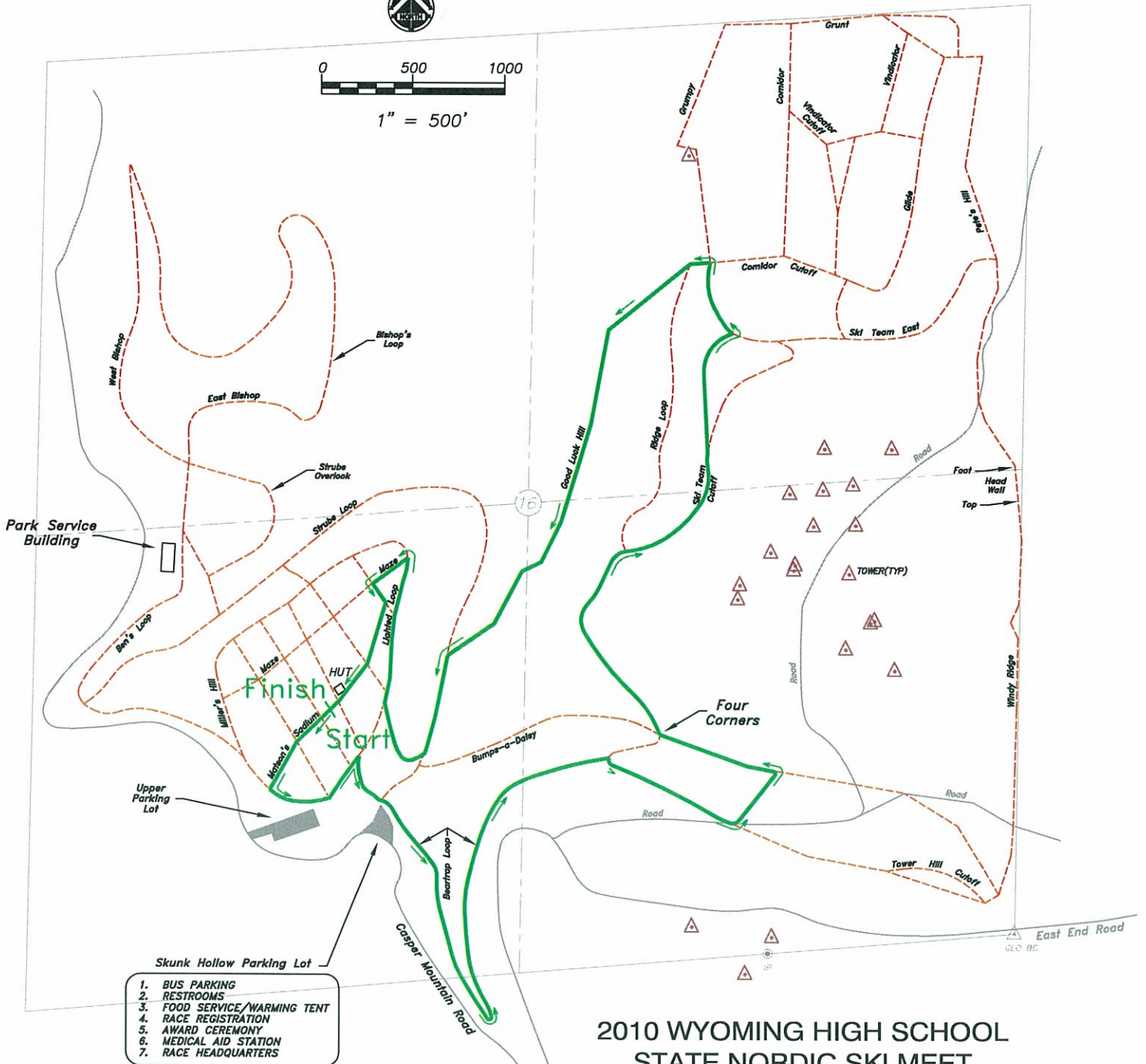

CASPER MOUNTAIN'S NORDIC SKI AREA

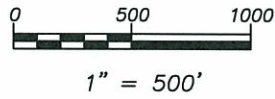

**2010 WYOMING HIGH SCHOOL
STATE NORDIC SKI MEET
CLASSIC / 5.05 km
Friday, February 26**



CASPER MOUNTAIN'S NORDIC SKI AREA



0 500 1000

1" = 500'

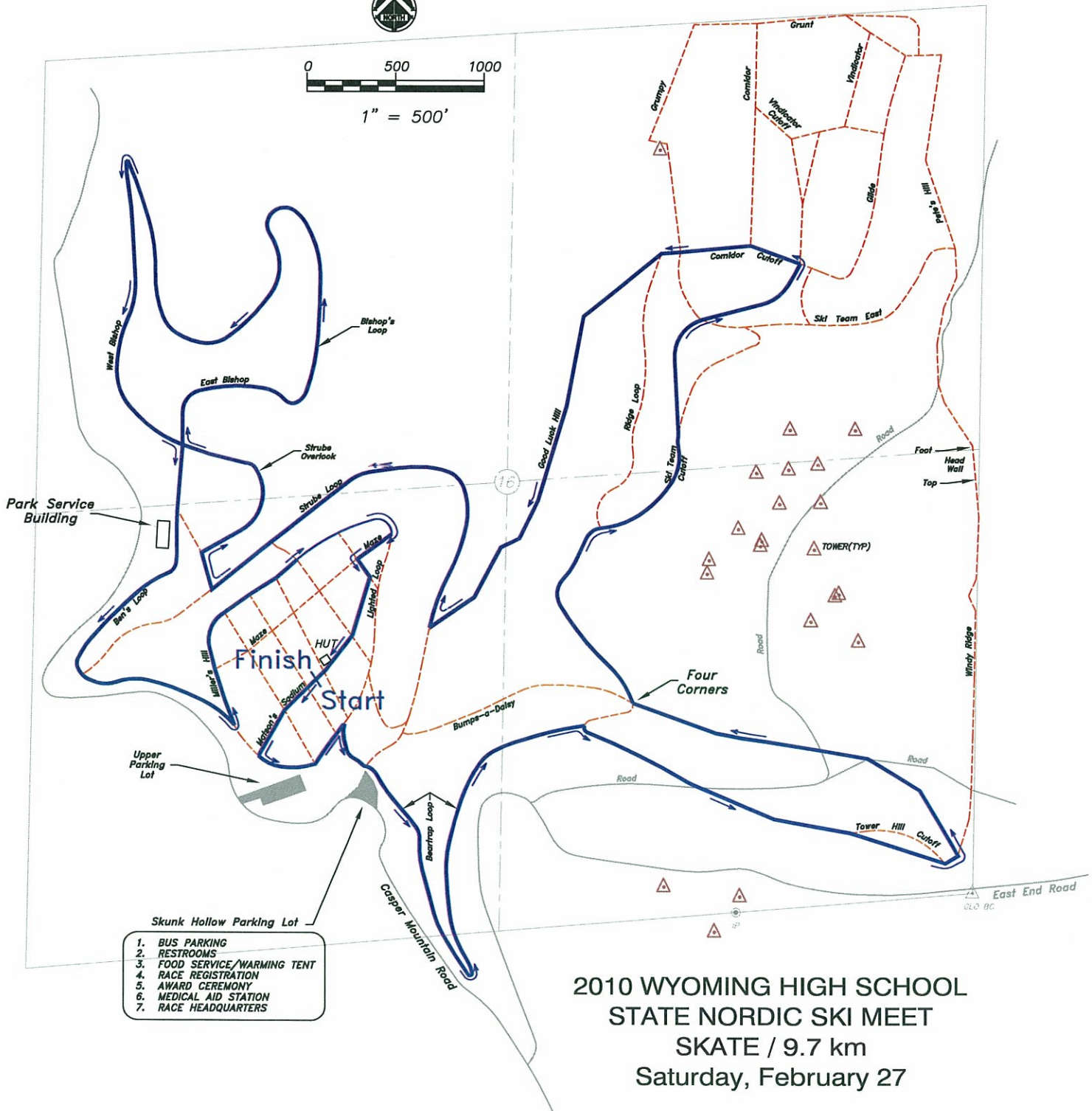

- 1. BUS PARKING
- 2. RESTROOMS
- 3. FOOD SERVICE/WARMING TENT
- 4. RACE REGISTRATION
- 5. AWARD CEREMONY
- 6. MEDICAL AID STATION
- 7. RACE HEADQUARTERS